

Note: At time of creating this project, Artistic Digitizer was Version 1.7

### WHAT YOU WILL NEED

- Janome Embroidery Machine (used MC550E)
- Embroidery Hoop SQ14b (140mm x 140mm)
- Janome Artistic Digitizer - full version  
(Note: Junior version of software is not suitable for project)
- Janome Red Tip Needle
- Janome Embroidery Threads (9 colours)
- Janome bobbin wound with Janome bobbinfil thread
- Dressmaking/Fabric Scissors
- Cutting Mat / Quilting Ruler / Rotary Cutter
- Ironing Board and Iron

### FABRIC & NOTIONS [fabric is enough for 4 coasters]

- Cotton quilting fabric: 50cm [20"] x width of fabric
- Tearaway Stabilizer: 50cm x 112cm [20"x 44"]
- Iron-on Pellon: 50cm x 112cm [20"x 44"]

### Janome Embroidery Threads used to create 4 Coasters

Common to each coaster

#275 Canary Yellow [part number 200921770]

#273 Honey Dew [part number 200921758]

*Purple Coaster*

#243 Royal Purple [part number 200921459]

#209 Pale Violet [part number 200921116]

*Pink Coaster*

#265 Crimson [part number 200921677]

#211 Pale Pink [part number 200921138]

*Blue Coaster*

#262 Blue Ink [part number 200921644]

#263 Sola Blue [part number 200921655]

*Red Coaster*

#242 Burgundy [part number 200921448]

#244 Cardinal Red [part number 200921430]



### CUTTING INSTRUCTIONS for 1 coaster

- Cotton Fabric : Cut 2 pieces 7"x 7" / 18cm x 18cm
- Iron-on Pellon: Cut 1 piece 7"x 7" / 18cm x 18cm
- Tearaway Stabilizer: 1 piece 9"x 9" / 23cm x 23cm

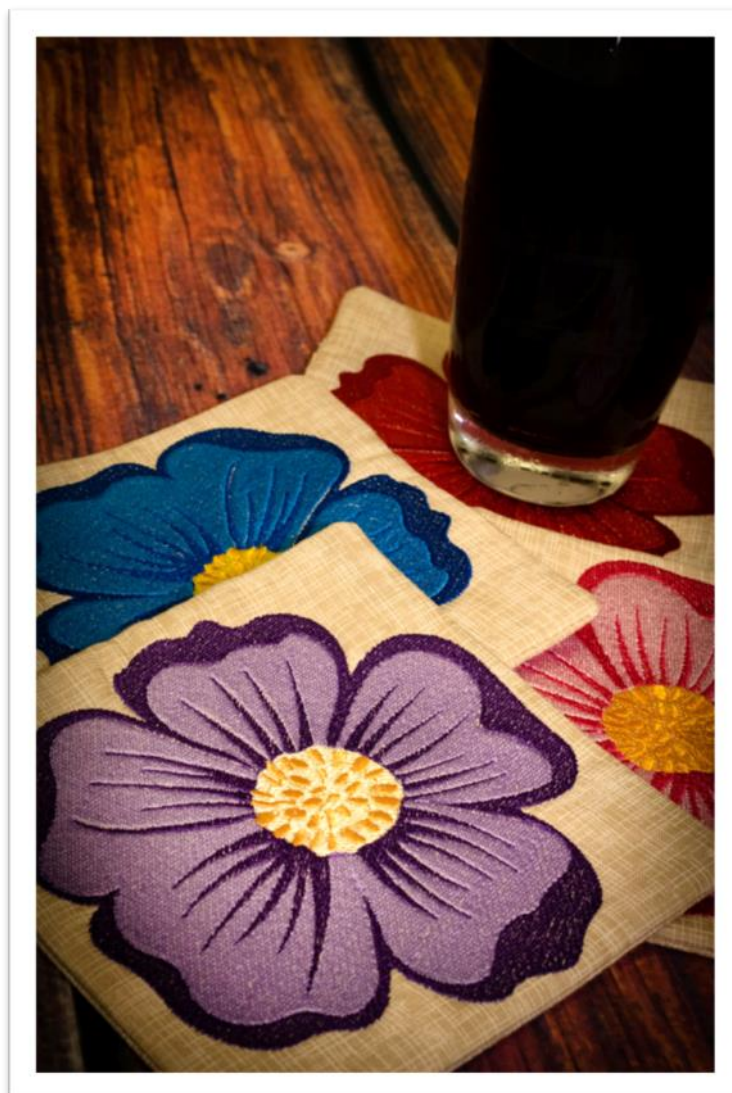

**NOTE:** Prior to starting this project, can you check/change the following tool setting. [If a change is made, close software and re-open for change to be applied.]

Open the Artistic Digitizer software.

At the top of the screen click on the word **TOOLS**, then in the dropdown menu select **OPTIONS**.

When the Options window opens, select the second tab called **TOOLS**. Go down to Digitizer section, change the Digitizer Tool to **Janome Digitizer**. This will change our manual digitizing mouse clicks to:  
Right Mouse Click = Curve  
Left Mouse Click = Straight line/angle

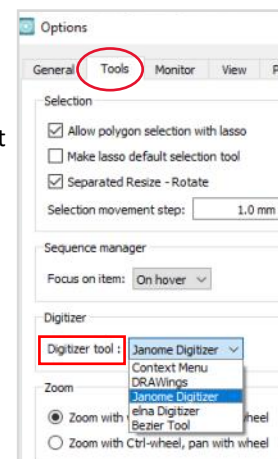

## INSTRUCTIONS

### Step 1

Open the Artistic Digitizer software.

*Note: Full version of the software is required.*

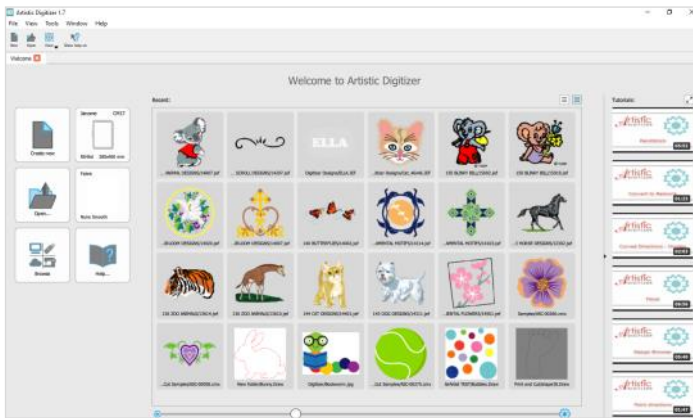

To select model machine and hoop, on the left of screen there are 6 icons.

Click the *machine/hoop* icon.

On the window that opens, use the up/down arrow to open menu and select the below.

Brand: Janome  
Machine: Select MC550E  
Hoop: Click on SQ14b

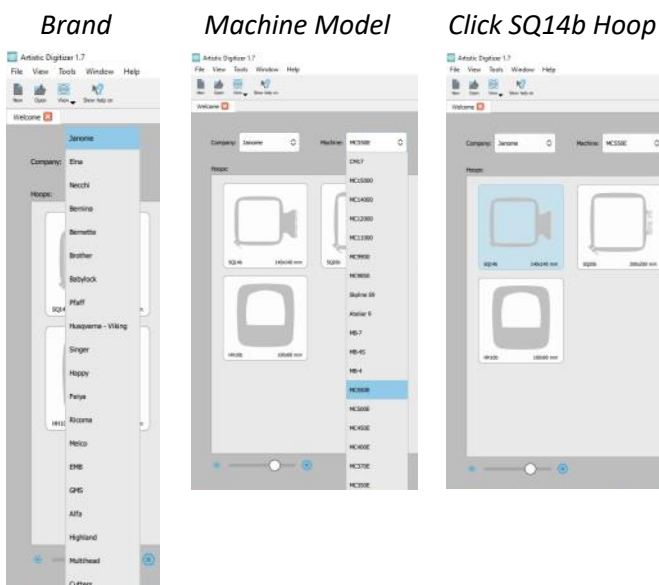

The welcome screen will appear again and *Hoop* icon will show your selection.

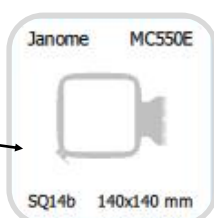

### Step 2

Let's select the fabric we will be are embroidering on.

*Note: The software automatically adjusts the embroidery design stitches, according to the selected fabric.*

On the left of screen, click on the *Fabric* Icon

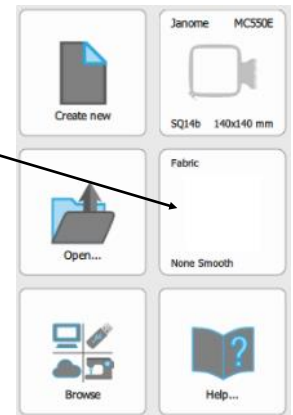

The below window will open.

Top selections are  
Embroidery Category: Smooth

Colour: White

*TIP: To get white, centre the circle on the colour wheel and move the slider on the right to the top.*

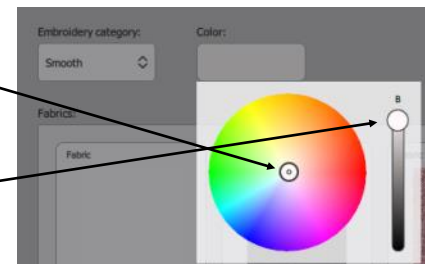

Select: Cotton 2 icon

Click on OK at the bottom right.

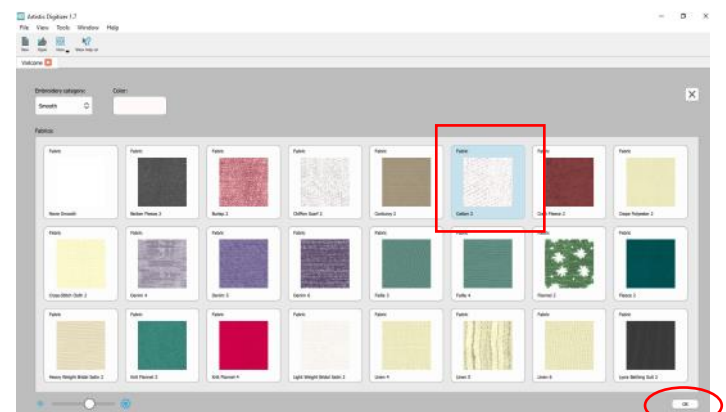

### Step 3 - Importing Design

Click on the Browse icon.

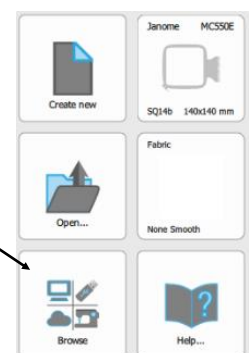

## Step 4

Locate the Built-in Designs in the Artistic Digitizer 1.7 Samples Folder. You need design ASC-00266

On Windows or MAC Computer design is located at: *Documents/Embroidery Designs/Artistic Digitizer 1.7 Samples*

When you have located design ASC-00266, double click on it to open it.



The design will open in the hoop, see below image.

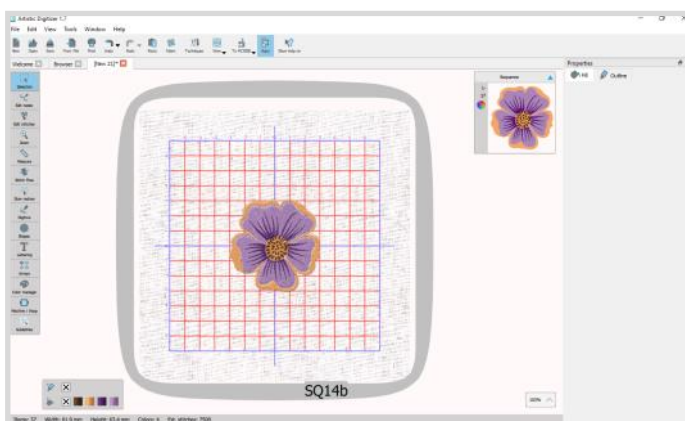

On the top toolbar, click on *Auto* icon, it will change to *Manual*.



Now, the *sequence* window will show the design sections in the thread color stitch-out order.

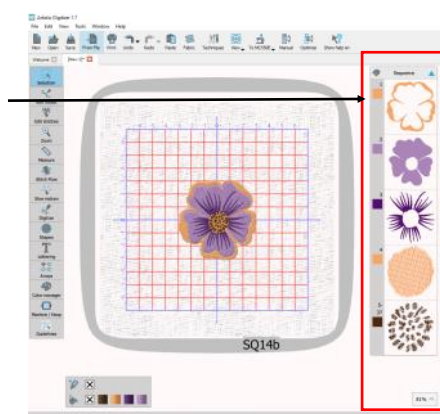

## Step 5 Resizing the Design

We need to select the whole design, the easiest way is to select the word EDIT at the top left of screen, in the menu that opens, click on *Select All*.

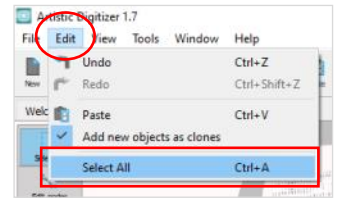

The design in the hoop will have blue outlines on each color section plus an outer blue line.

The below menu is open under the top toolbar.

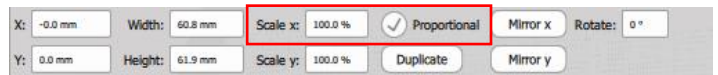

Make sure the *Proportional* circle is selected, then click on the *Scale x: 100.0* window, the number will highlight, now type in 180 and hit Tab Key.

The design will now be increased proportionally to 180% Deselect the design by clicking within the hoop but not on the design.

## Step 6 Changing colours

The *color chart* is located on the bottom right tab, click on it to open it.

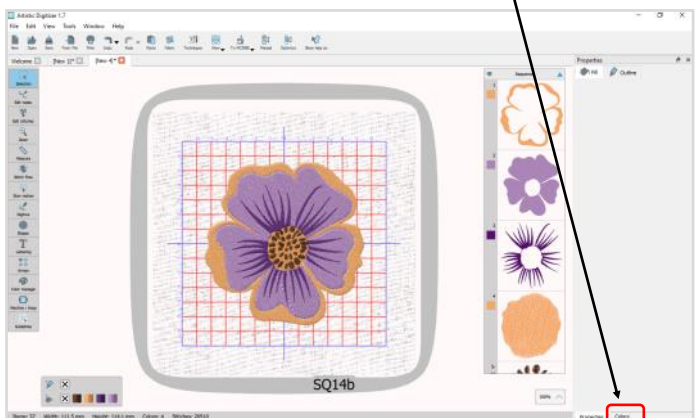

If you do not have the color tab, add it, by clicking on the word VIEW [top of screen], a menu opens, scroll down to Toolbars and select Colors.

The *color chart* tab will appear.

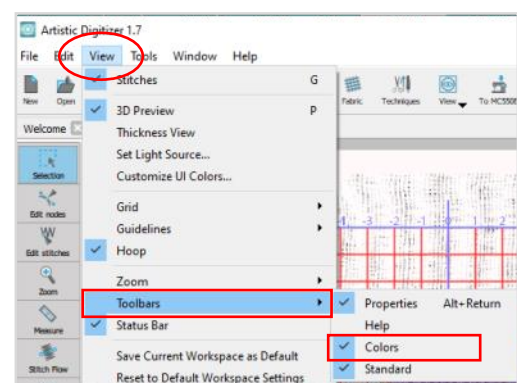

## Step 7

Click on the first color in the *Sequence* window, a blue outline box will appear, the color will be selected on the design with a pink outline. Scroll through the color chart and locate #243 Royal Purple. Click on the solid color fill and the color will change on your design.

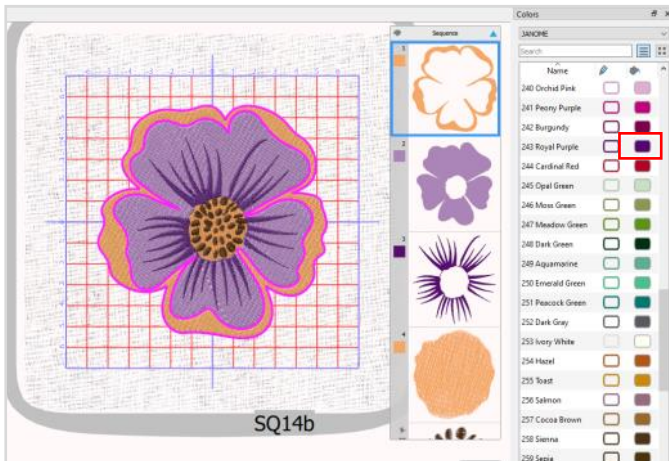

**NOTE:** If your color chart is not showing Janome colors, at top of the chart [above search], the box has a drop down arrow, click it, select Janome from the thread menu.

Continue changing the colors.

Select color 3 change to #243 Royal Purple

Select color 2 change to #209 Pale Violet

Select color 4 change to #275 Canary Yellow

Select color 5 change to #273 Honey Dew

Now, deselect the design by clicking within the hoop away from the design.

Your design should look the same as pictured below.



## Step 8 Create Borders

On left toolbar running down the Screen, select the *Digitize outline shape tool*

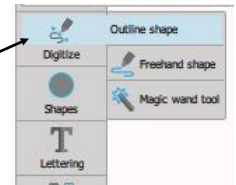

Create the same border as in the below image.

Start at #1 with a left mouse click [LMC], you will have a line attached to your mouse pointer, move to #2 and LMC, move to #3 & LMC, continue on until you have LMC at #6. On the computer keyboard, hit enter key once to set the border, hit enter key again to create the stitches. The default stitch is a straight stitch at stitch length 2.5mm

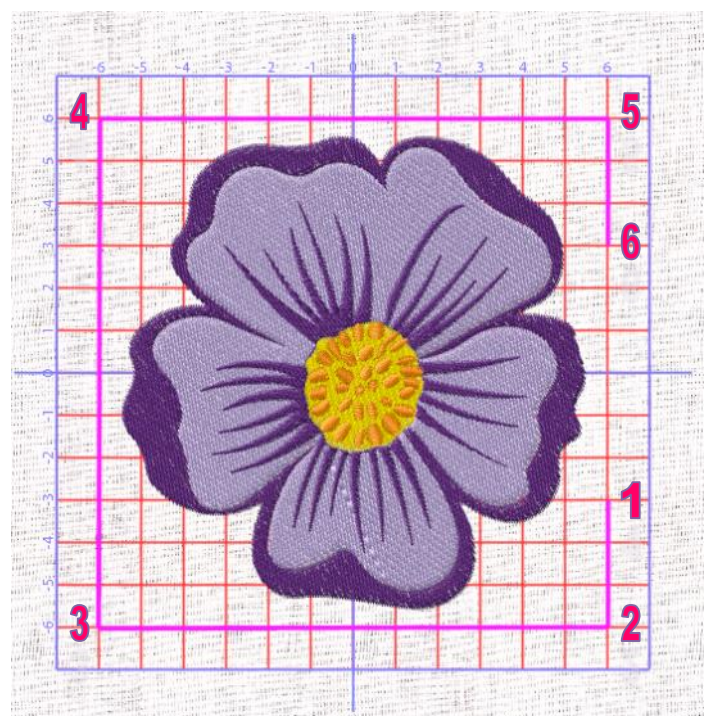

In the *Sequence* window your created border line is at the bottom and it should be selected, if not, click it to select it. On left toolbar, select the first tool *Selection*.

*Tool Options pane* opens, change the width to 132mm and hit Tab Key on computer keyboard. The border line increases in size proportionally to 132mm x 132mm.

Next, select the *Properties Tab* located under the color chart window.

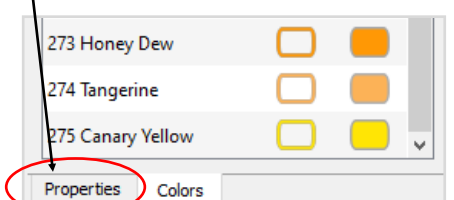

## Step 9

The created border should still be selected on the *Sequence* window on the right, if not, select it. The *Selection Tool* at the top of the left toolbar should also still be selected and the tool options pane is open. Click on Duplicate.

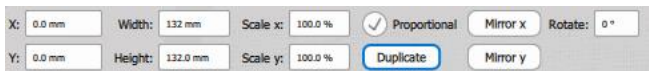

You will now have 2 borders, one on top of the other.

On the *Sequence* window they are shown together, as they are the same thread color.

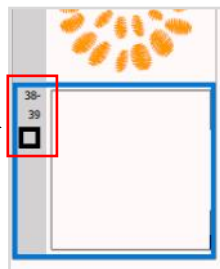

With the border still selected,

Click on *color chart* tab at the bottom right of the window and select a color not currently used within the design. Select the outline color icon.

We selected #257 Cocoa Brown

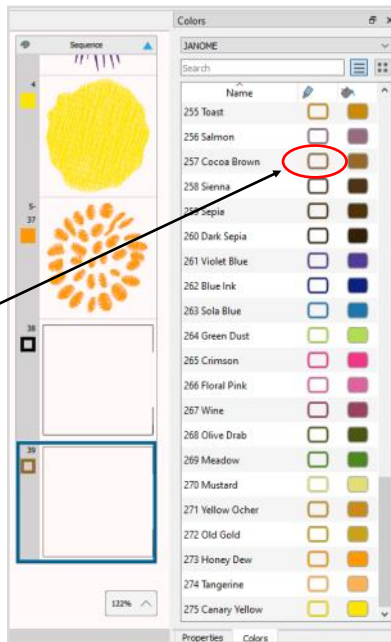

## Step 10 Changing stitch

Select the *Properties* Tab under the *color chart*. Click on the *Stitches* box.

The below window will open. Find and select stitch **ZigZag08**

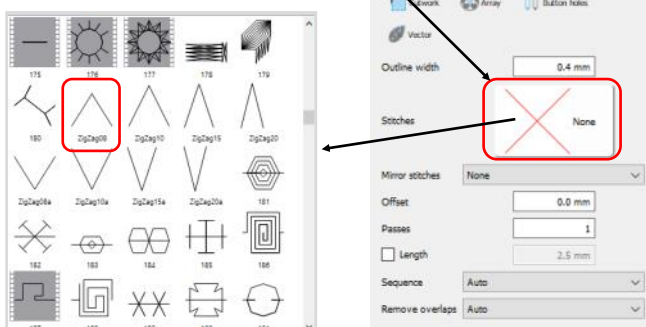

## Step 11

With zigzag stitch still selected in the design, within the *Properties* window change the *Offset* from default 0.00mm to 0.80mm and hit Enter or Tab Key.

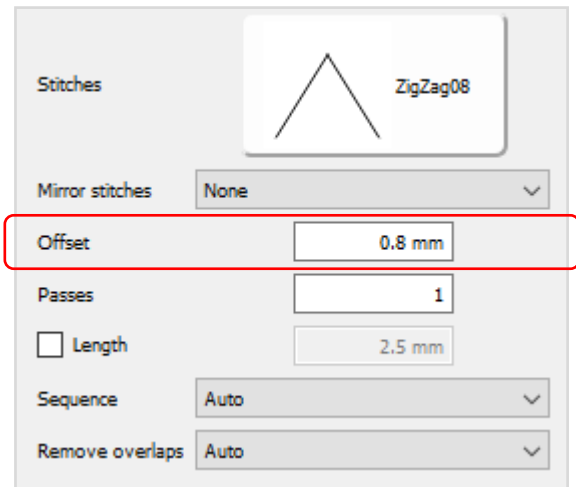

## Step 12

In the *Sequence* window select the 2nd color - pale violet. Select *Compensation* by clicking on the small square, then change the figure from 0.2mm to 0.6mm

This slightly increases the pale violet stitch coverage onto the royal purple.

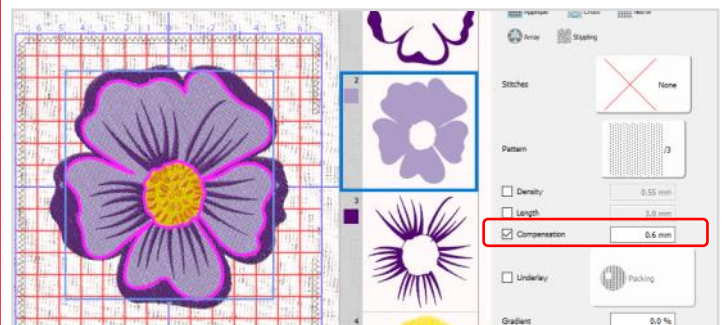

## Step 13

In the *Sequence* window scroll down and select the first outline border. Click on duplicate in the *tools option* pane.

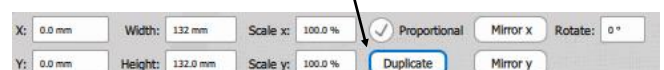

As in step 9, change the color, to one not currently used. In the *Sequence* window an additional box will appear being the duplicate outline border with your selected thread color.

## Step 14

If the duplicate outline border is not selected in the *Sequence* window, select it now.

In *Properties* window, click on Stitches.

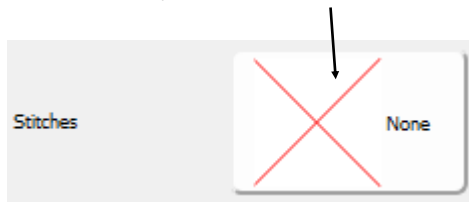

Select stitch called **Double**

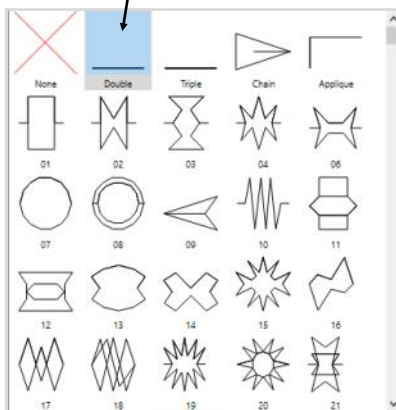

In *Sequence* window

Select the last box and move it up one position by Click, Hold & Drag it over the box above, then Drop it.

The box should now be 2nd last.

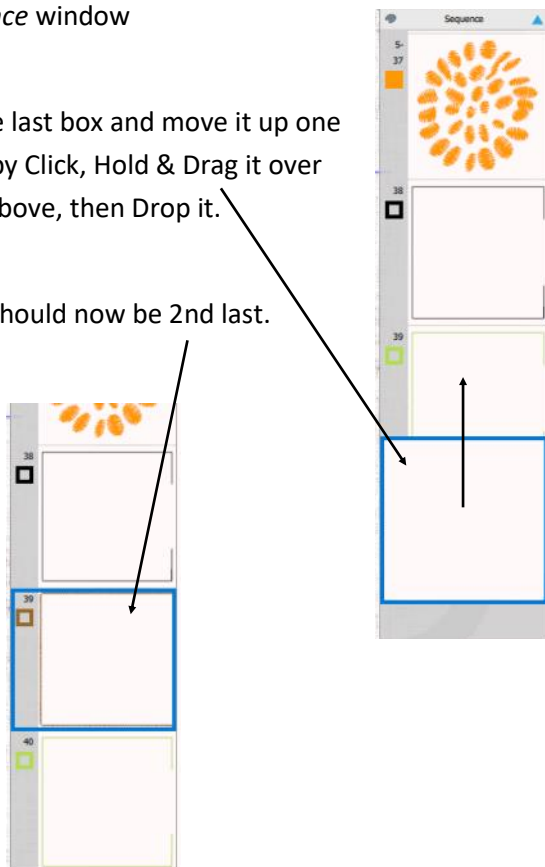

## Step 15 Saving the design to USB Stick

*Tip: If your USB Stick has never been used, it needs to be formatted to your Janome embroidery machine.*

*Insert the USB into your embroidery machine.*

*Option 1: Save a built-in embroidery design to the USB.*

*Option 2: Format USB in the machines SET Menu.*

To save your design to a USB Stick, insert it into your computer. On the top toolbar, click on the *To Machine* Icon, the below pictured menu opens.

Select *To USB Storage*

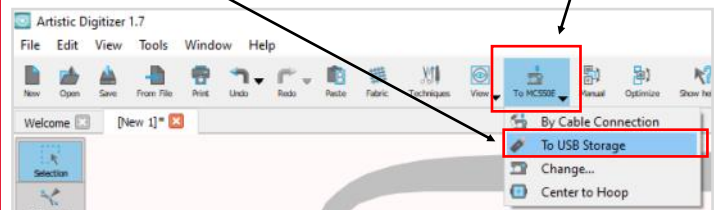

The below window opens.

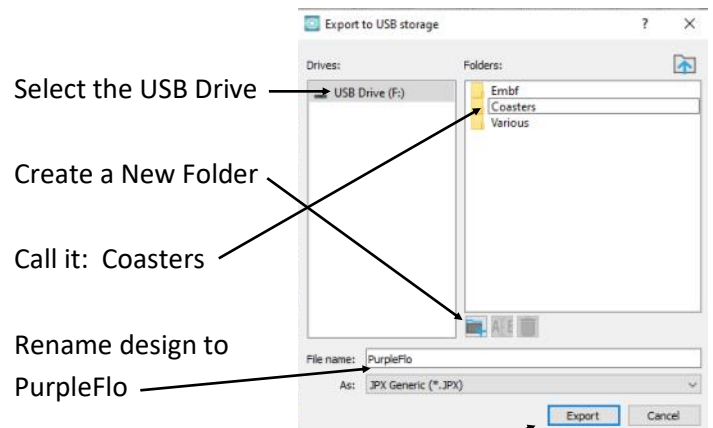

Open the Coasters Folder.

Click on Export at the bottom right of window.

The *Export to USB Storage* window will disappear.

To check your design saved, open the USB via the *To Machine* Icon. Select USB Drive, Open the Coasters Folder and your design should be saved as pictured below. Click Cancel, bottom right to close the window.

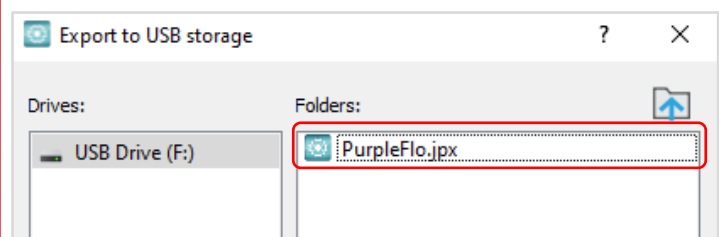

Safely, remove the USB Stick from your computer

## Step 16 Hooping the fabric

Layer your fabrics in this order from the bottom up and hoop them in the SQ14b Hoop.

1. Tear-away stabilizer
2. Iron-on pellon [glue side facing up]
3. Cotton quilting fabric [right-side up]



**Note:** Do not iron the pellon to the fabric.

## Step 17

Insert the USB into embroidery machine.

Open *PurpleFlo* design on the USB , in Coasters Folder.

Thread the machine with the first embroidery thread colour and bobbin with Janome Bobbinfil thread.

Attach Hoop to machine.

Stitch the flower following the color changes.



## Step 18

Before we stitch the outline borders, place the second piece of quilting cotton fabric, right-side down covering the design and the hoop.

*Tip: For border stitches, use an embroidery thread color that matches your fabric, can also use in the bobbin.*

The 3 border outlines in the design can be stitched with the same color. Each time the machine stops for a color change, continue on until design is complete.



## Step 19 Finishing

Remove hoop from the machine.

Remove embroidery from the hoop.

Gently, remove tear-away exposing the pellon.

Trim the fabric to a quarter inch [6mm] from the stitching line, trim excess on corners.



Turn-out to the right-side and slip stitch the opening.

Press the coaster, to activate the glue on the iron-on pellon to adhere the pellon and embroidered fabric.

FINISH

